

PLANTA DE COBERTURA DO RESERVATÓRIO
1/25

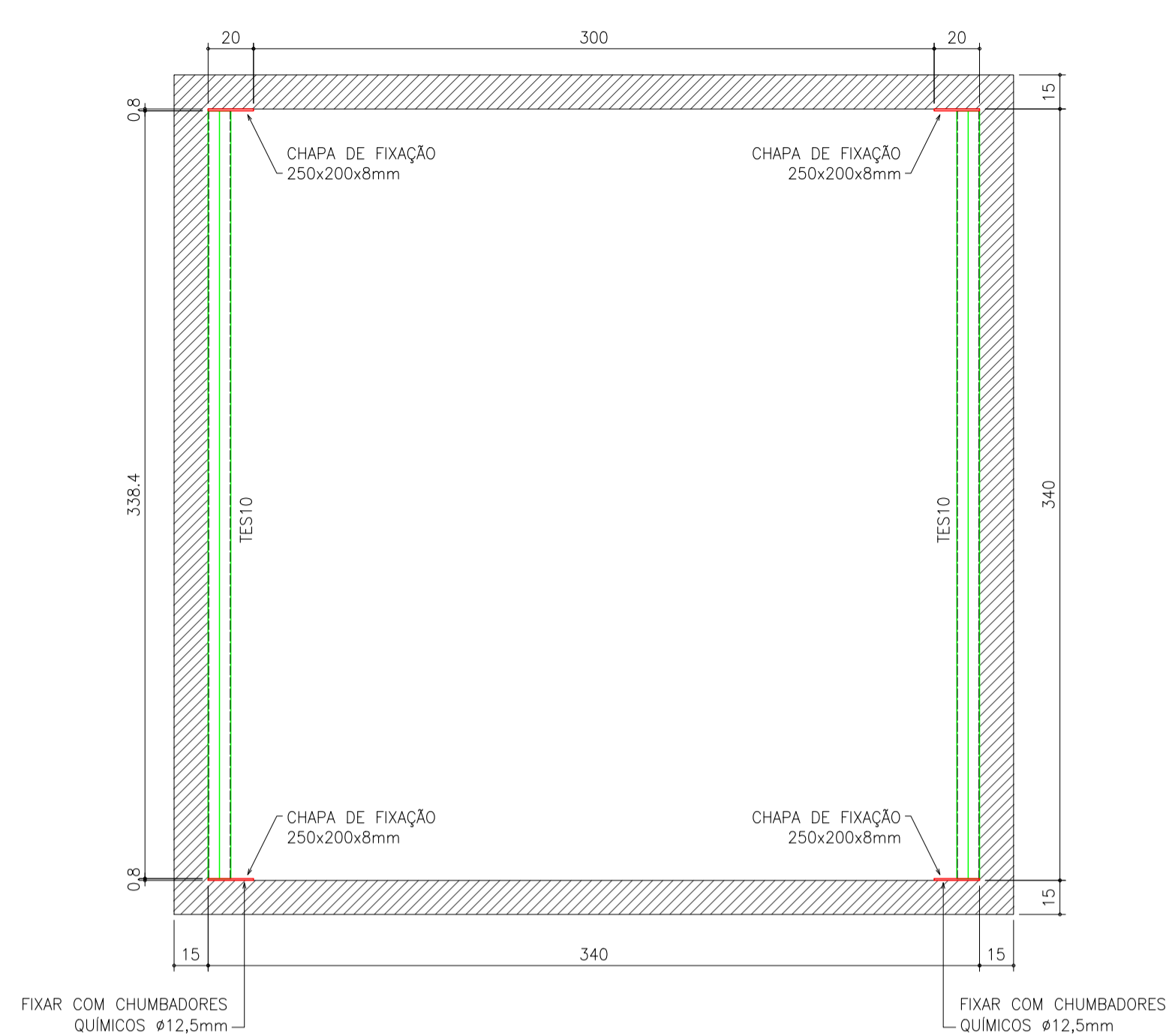
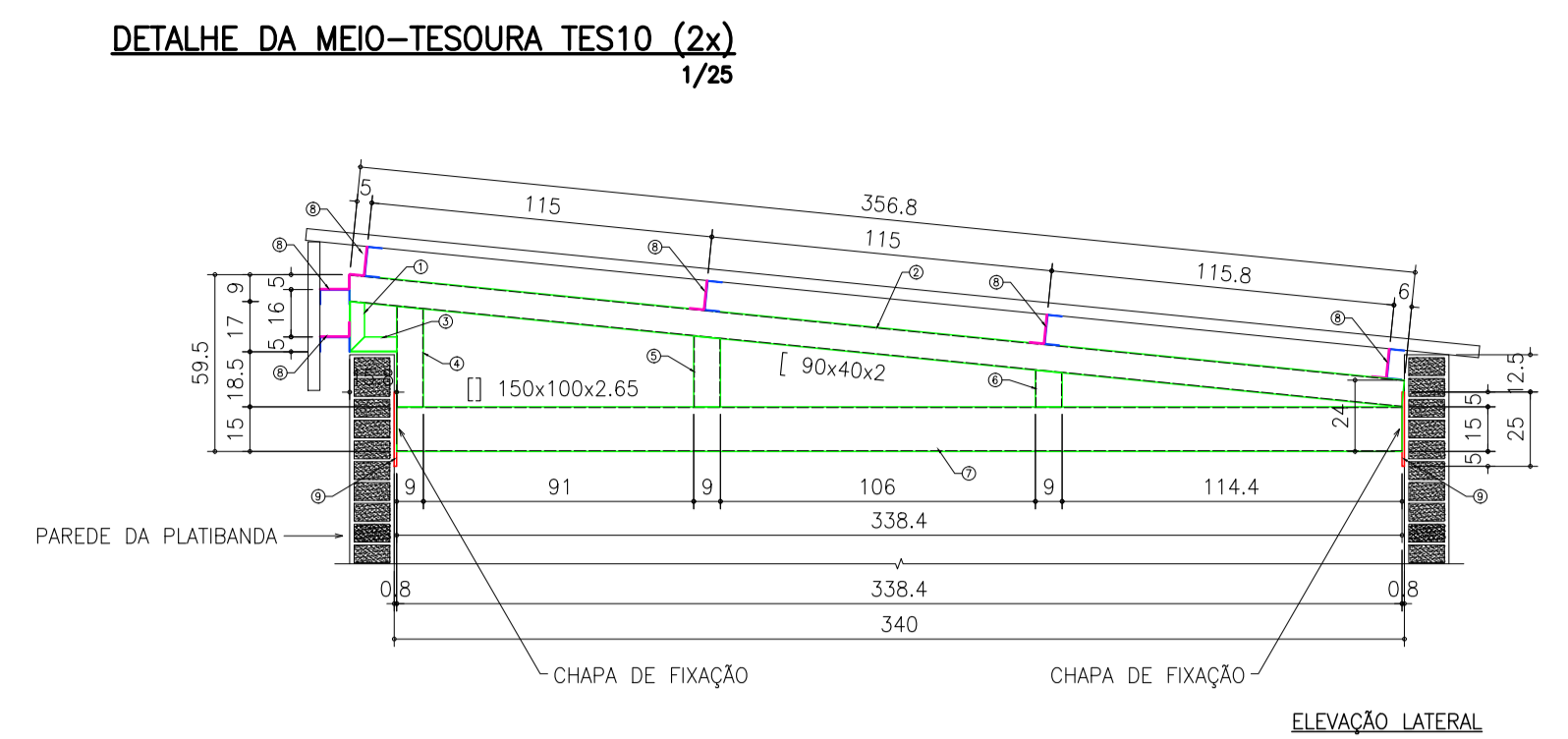
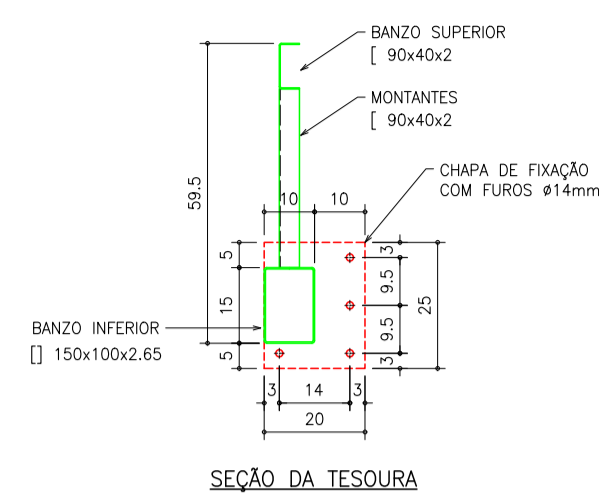

PLANTA DE LOCAÇÃO DAS TESOURAS DO RESERVATÓRIO
1/25

[illegible]

DETALHE DA MARQUISE (11x)
1/25

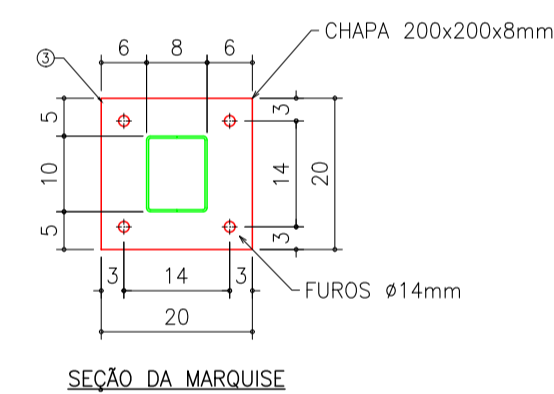
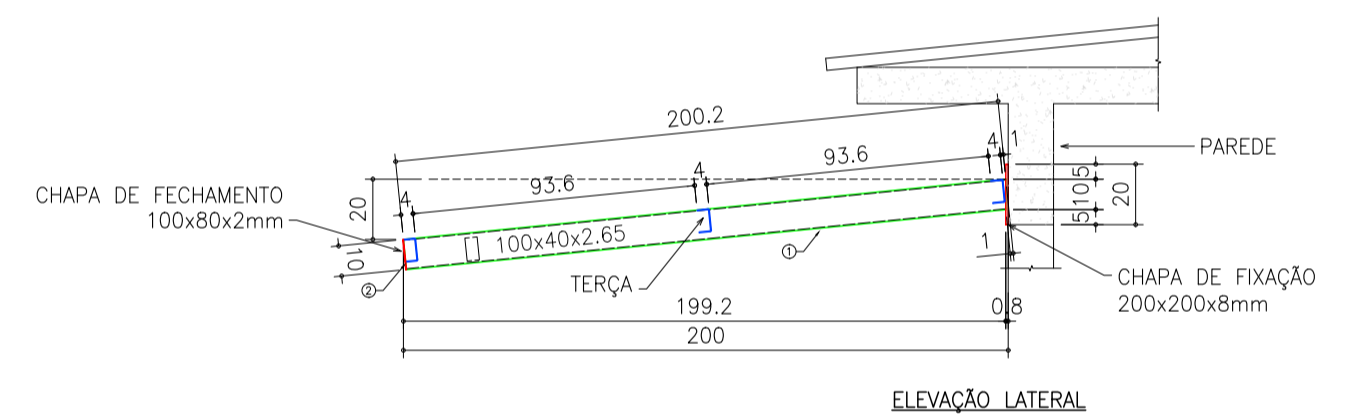
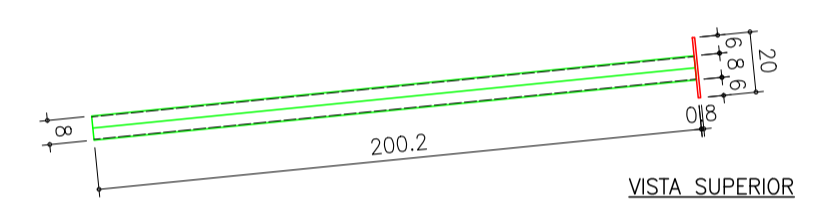
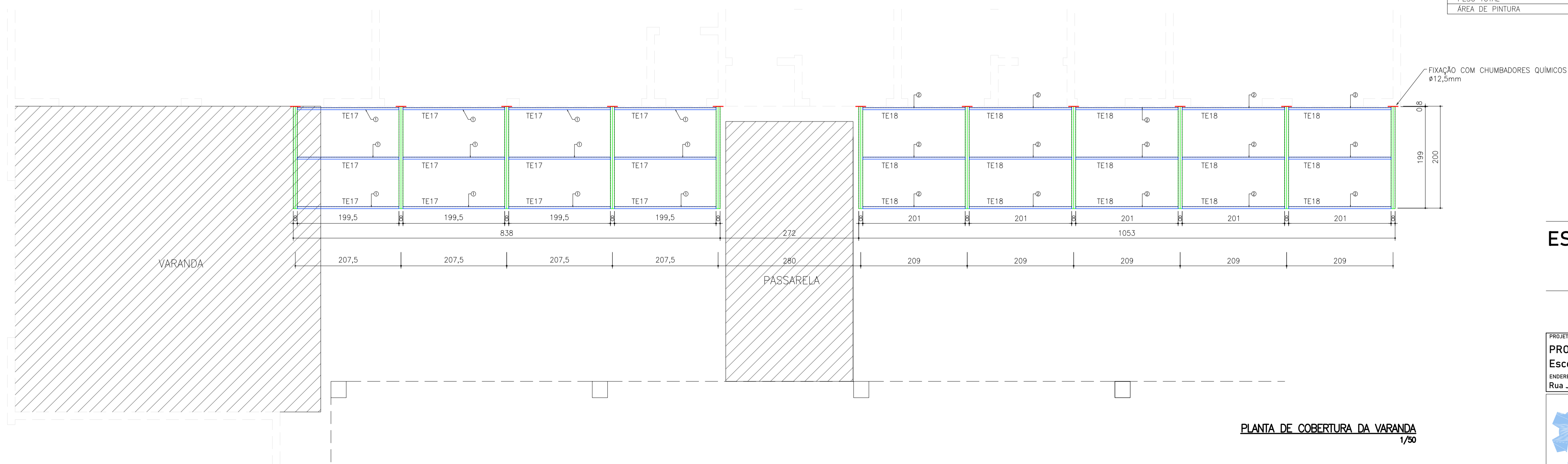
[illegible]

PLANTA DE COBERTURA DA VARANDA
1/50

ESCRITÓRIO MODELO DE ENGENHARIA - UFSM

Eng. civil André Lübeck
 SIAPE: 1692336 / CREARS: 140441

Eng. civil Almir Barros da S. Santos Neto
 SIAPE: 2300182 / CREARS: 092776

RESPONSÁVEIS TÉCNICOS:

RESPONSÁVEIS TÉCNICOS:

PROJETO:	PROJETO ESTRUTURAL - METÁLICA
	Escola Municipal de Ensino Fundamental Vicente Farencena
ENDEREÇO:	Rua João da F. e Souza, S/N - Camobi, Santa Maria - RS.

00

18/01/2026

Indicada

EST
09/11

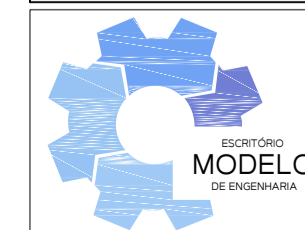

PRANCHA:	<p>Detalhamento da cobertura do reservatório</p> <p>Planta de cobertura do reservatório</p> <p>Planta de cobertura da marquise</p> <p>Detalhamento da marquise</p>
----------	--